

# TORQUE LIMITERS TLEU

RoHS compliant



Magnetic hysteresis torque limiters

## Features

- Torque is generated by the magnetic force
- Wide variety of torque as the same shape
- Small size
- Light weight
- High durability
- High allowable rotation speed
- Low torque ripple
- Good heat dissipation due to the aluminum housing

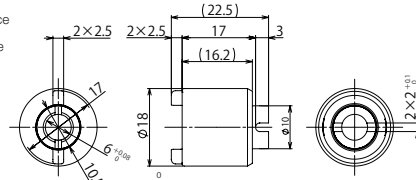

General Tolerance : ±0.3

## Standard specifications

Application shaft [mm]	Allowable rotation speed [min <sup>-1</sup> ]	Rotation direction	Torque [mN·m] (lbf·in)	Product name
Φ6 <sup>+0</sup> <sub>-0.03</sub>	2000	Bidirectional	5 (0.044)	TLEU1-618-5W
			10 (0.089)	TLEU1-618-10W
			15 (0.133)	TLEU1-618-15W
			20 (0.177)	TLEU1-618-20W
			25 (0.221)	TLEU1-618-25W
			30 (0.266)	TLEU1-618-30W
			35 (0.310)	TLEU1-618-35W
			40 (0.354)	TLEU1-618-40W

## Product specifications

**Durability** Tested at 2000min<sup>-1</sup>(2000rpm) and measured at 500min<sup>-1</sup>(500rpm)

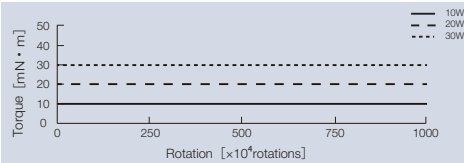

## Main materials

Housing	Aluminum
Sleeve	Super engineering plastic
Bush	Copper sintering
Magnet	Neodymium-based bond magnet Semi-hard magnet

**Temperature characteristics** Torque measured at 500 min<sup>-1</sup> (500 rpm)

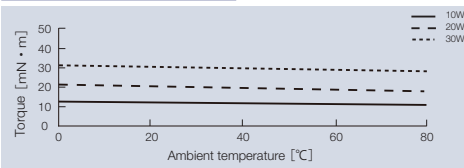

## Mounting image

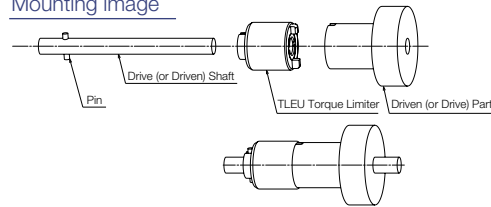

## Speed characteristics

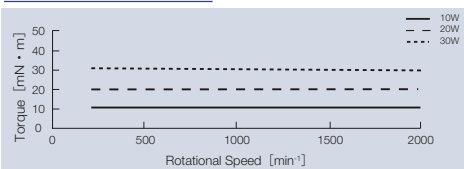

# TORQUE LIMITERS TLD

RoHS compliant



Spring friction torque limiters

## Features

- Various torque selections
- Small size
- Light weight
- Reasonable price

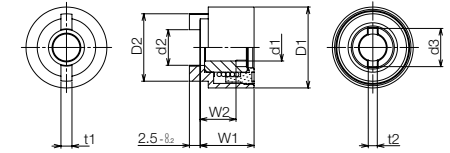

General Tolerance : ±0.2

## Standard specifications

Application shaft [mm]	Allowable Rotation Speed [min <sup>-1</sup> ]	Rotation Direction	Dimensions [mm]								Torque [mN·m] (lbf·in)	Product name	
			t1	D2	d2	W2	W1	d1	D1	t2			d3
Φ6 <sup>+0</sup> <sub>-0.03</sub>	400	Bidirectional	2.5 <sup>0</sup> <sub>-0.1</sub>	15 <sup>0</sup> <sub>-0.2</sub>	8.2 <sup>+0.2</sup> <sub>0</sub>	8	12	6 <sup>+0.08</sup> <sub>-0.02</sub>	18 <sup>+0.1</sup> <sub>-0.2</sub>	2 <sup>+0.10</sup> <sub>-0.02</sub>	8.4 <sup>+0.2</sup> <sub>0</sub>	19.6 (0.173)	TLD4-618-20W
												29.4 (0.260)	TLD4-618-30W
												39.2 (0.347)	TLD4-618-40W
												49.0 (0.434)	TLD4-618-50W-1
												58.8 (0.520)	TLD4-618-60W
												68.6 (0.607)	TLD4-618-70W-1
Φ8 <sup>+0</sup> <sub>-0.036</sub>	50		4 <sup>0</sup> <sub>-0.1</sub>	17 <sup>0</sup> <sub>-0.2</sub>	8.2 <sup>+0.2</sup> <sub>0</sub>	11.5	15.5	8 <sup>+0.10</sup> <sub>-0.02</sub>	22 <sup>+0.1</sup> <sub>-0.3</sub>	2.1 <sup>+0.10</sup> <sub>-0.08</sub>	10.4 <sup>+0.2</sup> <sub>0</sub>	196.0 (1.735)	TLD7-822-200W
												392.0 (3.469)	TLD7-822-400W

## Product specifications

**Durability** Tested at allowable rotational speed.

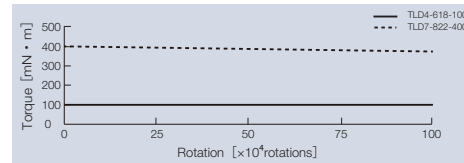

## Main materials

Housing	Plastic (POM)
Cap	Plastic (POM)
Sleeve	Iron-based sintering
Spring	Piano wire
Washer	Plastic (PET)

**Temperature characteristics** Measured at allowable rotational speed.

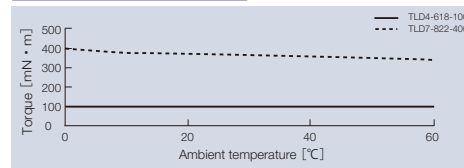

## Mounting image

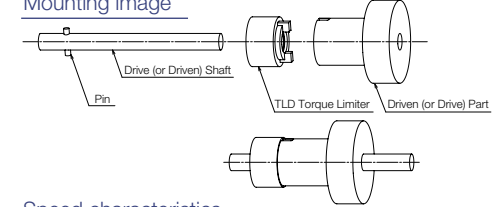

## Speed characteristics

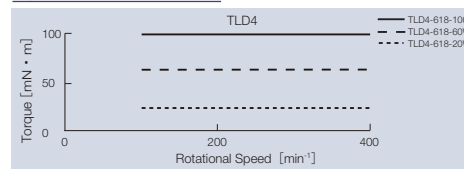

## Speed characteristics

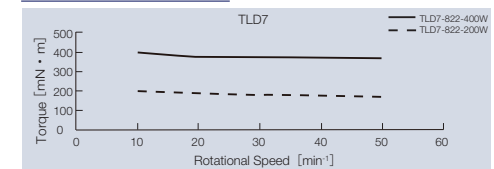

TOK, Inc.

1-17-12, Azusawa, Itabashi, Tokyo, 174-8501, Japan  
Tel +81-3-3969-1584 Web tok-inc.com/en

CAD data download



TOK, Inc.

1-17-12, Azusawa, Itabashi, Tokyo, 174-8501, Japan  
Tel +81-3-3969-1584 Web tok-inc.com/en

CAD data download

