

TORQUE LIMITERS

TLEU

RoHS compliant



Magnetic hysteresis torque limiters



Features

- Torque is generated by the magnetic force
- Wide variety of torque as the same shape
- Small size
- Light weight
- High durability
- High allowable rotation speed
- Low torque ripple
- Good heat dissipation due to the aluminum housing

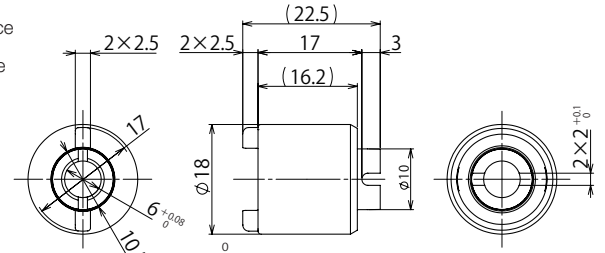

[mm]

General Tolerance : ± 0.3

Standard specifications

Application shaft [mm]	Allowable rotation speed [min ⁻¹]	Rotation direction	Torque [mN·m] (lbf·in)	Product name
$\Phi 6^{+0}_{-0.03}$	2000	Bidirectional	5 (0.044)	TLEU1-618-5W
			10 (0.089)	TLEU1-618-10W
			15 (0.133)	TLEU1-618-15W
			20 (0.177)	TLEU1-618-20W
			25 (0.221)	TLEU1-618-25W
			30 (0.266)	TLEU1-618-30W
			35 (0.310)	TLEU1-618-35W
			40 (0.354)	TLEU1-618-40W

Product specifications

Durability

Tested at 2000min⁻¹(2000rpm) and measured at 500min⁻¹(500rpm)

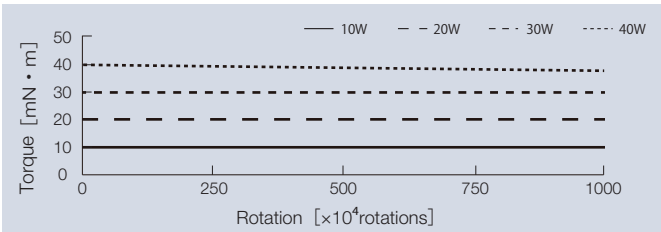

Main materials

Housing	Aluminum
Sleeve	Super engineering plastic
Bush	Copper sintering
Magnet	Neodymium-based bond magnet Semi-hard magnet

Temperature characteristics

Torque measured at 500 min⁻¹ (500 rpm)

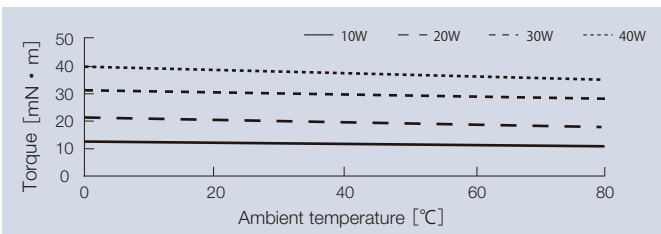

Mounting image

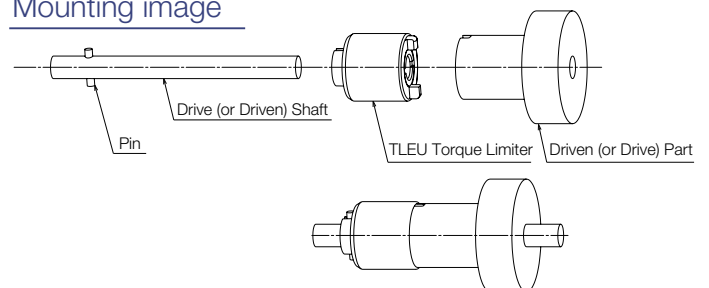

Speed characteristics

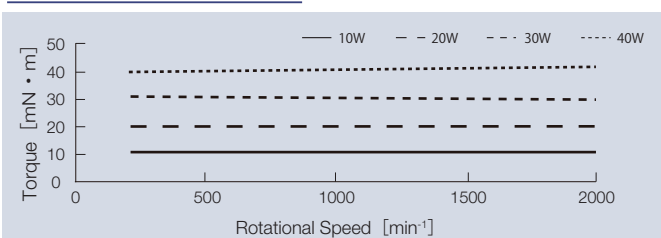

TOK, Inc.

1-17-12, Azusawa, Itabashi, Tokyo, 174-8501, Japan

Tel +81-3-3969-1584 Web tok-inc.com/en

CAD data download

